

Zone 10 (Viewpoint - Bay Point Area)
Landscaping, irrigation, and related improvements located within:

1. Open Space - Slope easement areas (up to 10 feet);
2. Paved walking trails (located on Pomo Street and the slope behind Skyharbour Lane);
3. Viewpoint Park* (a.k.a. Lehman Park - 0.08 acres). Location: Pomo Street and Seaciff Place;
4. Landscaping at the end of Skyharbour Lane and Waterview Place cul-de-sacs; and
5. Frontage landscaping on the north side of Evora Road.

Assessment Diagram Contra Costa County LL-2 Zone 10 Viewpoint - Bay Point Area

*Please note: Ambrose Recreation & Park District is responsible for the maintenance of Viewpoint Park per the June 26, 2012 Joint Power of Agreement (JEPA) between the County and Ambrose.

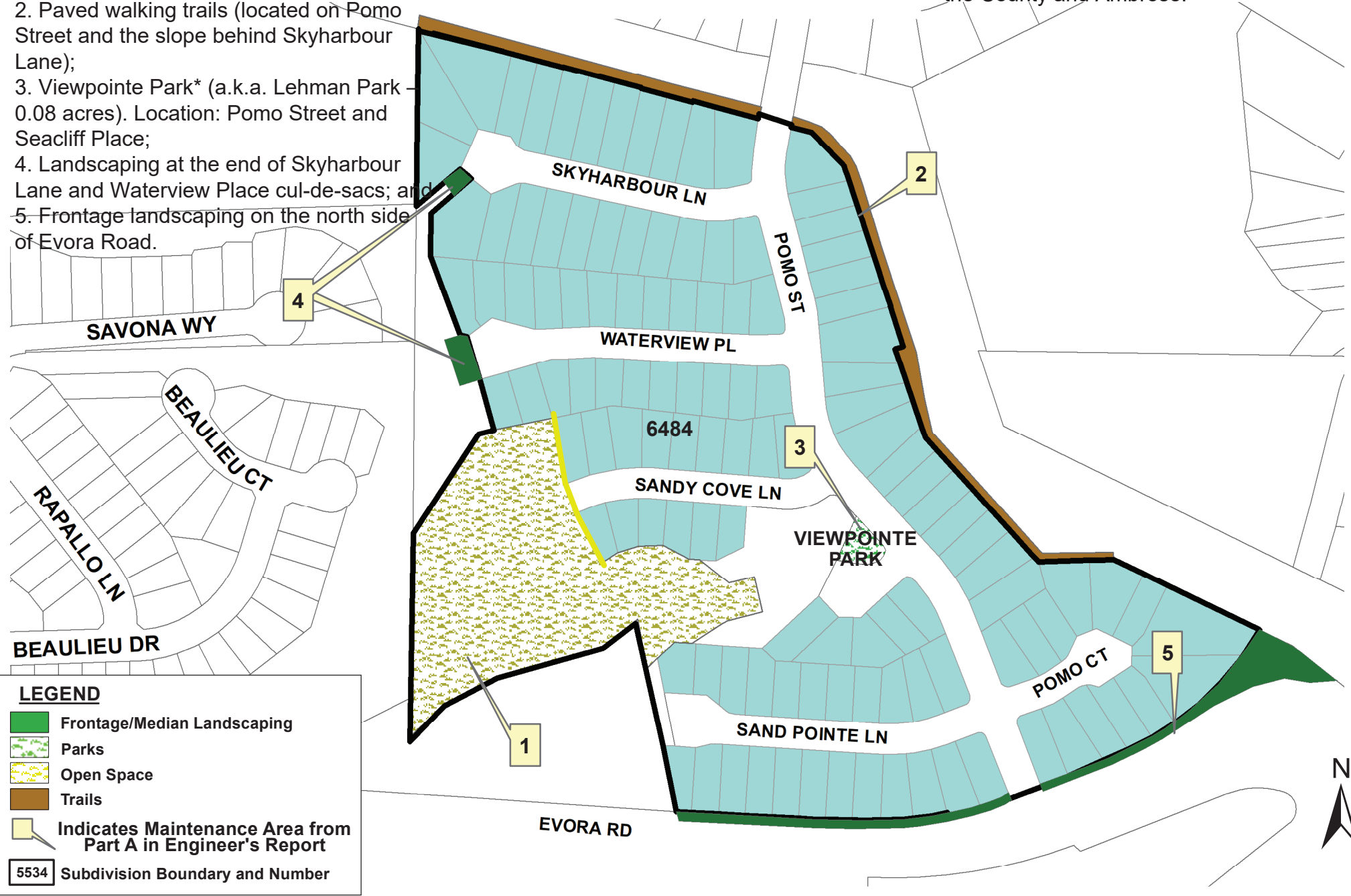

LEGEND

- Frontage/Median Landscaping
- Parks
- Open Space
- Trails
- Indicates Maintenance Area from Part A in Engineer's Report
- 5534 Subdivision Boundary and Number

